

1:200 METER

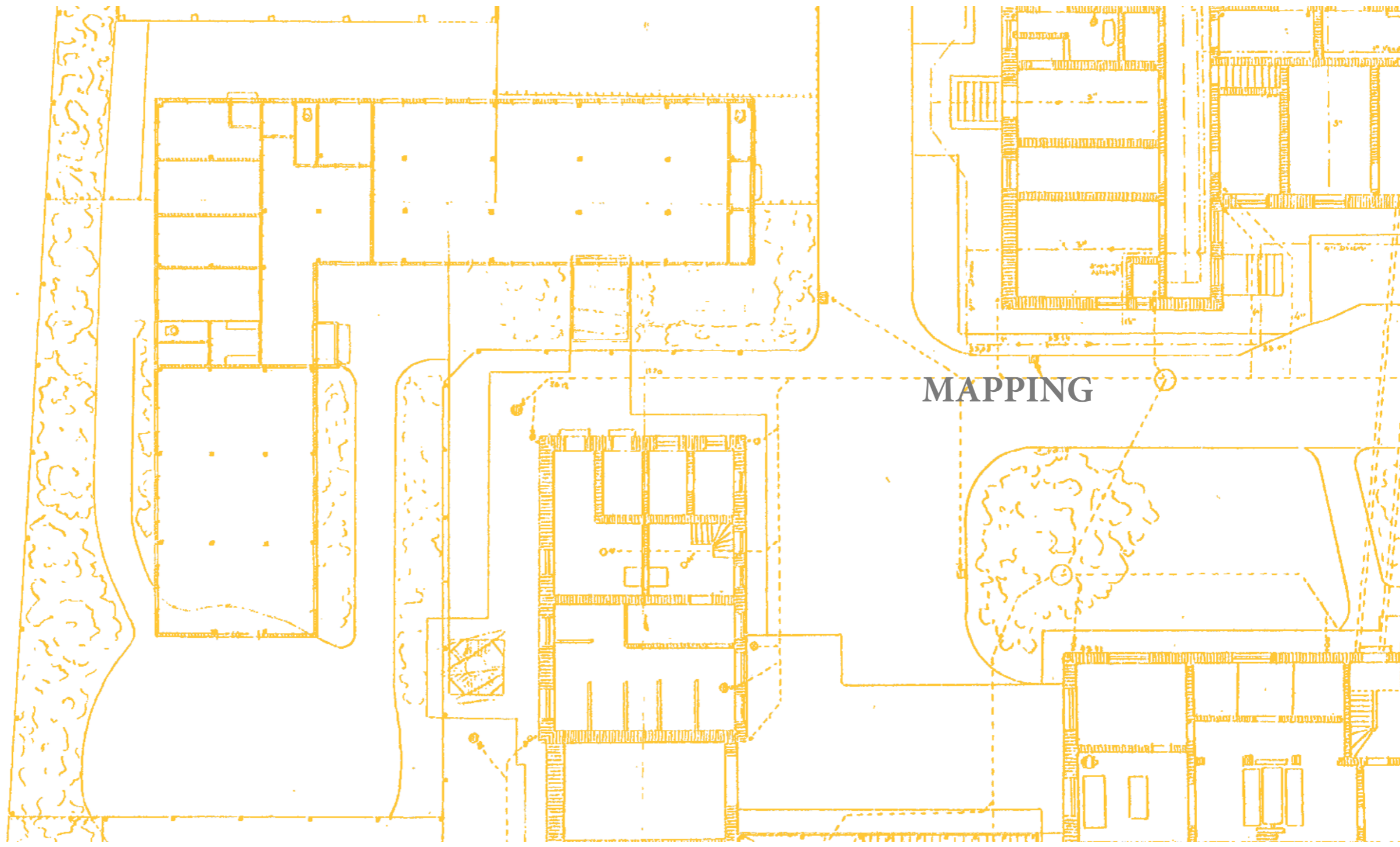

MAPPING

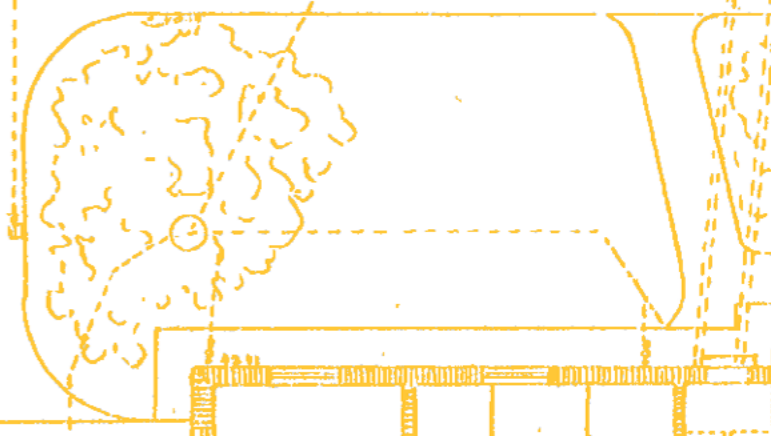
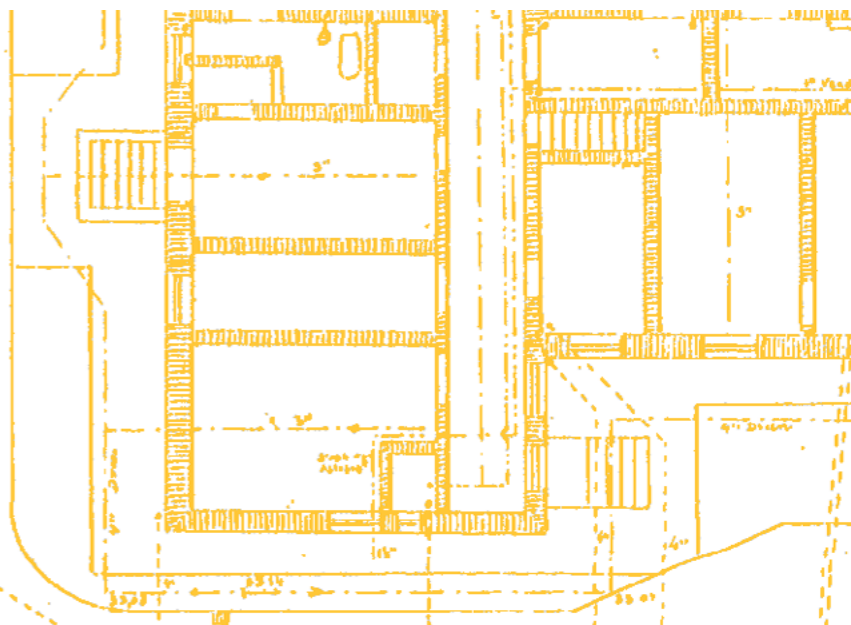

*En historisk mulighed - Udviklingsplan for Frederiksberg Hospital*

*Afgangprojekt juni 2018*

*Rasmus Boysen Feddersen, stud5300*

*Tim Bruun, stud5337*

*Det Kongelige Danske Kunstakademis Skoler  
for Arkitektur, Design og Konservering*

*Bosætning, Økologi og Tektonik*

*Vejledere:*

*Anne Beim*

*Nathan Romero Muelas*

# INDHOLD

---

FREDERIKSBERG	3
FREDERIKSBERG HOSPITAL	13

**FREDERIKSBERG**

01

# SCHWARTZPLAN

---

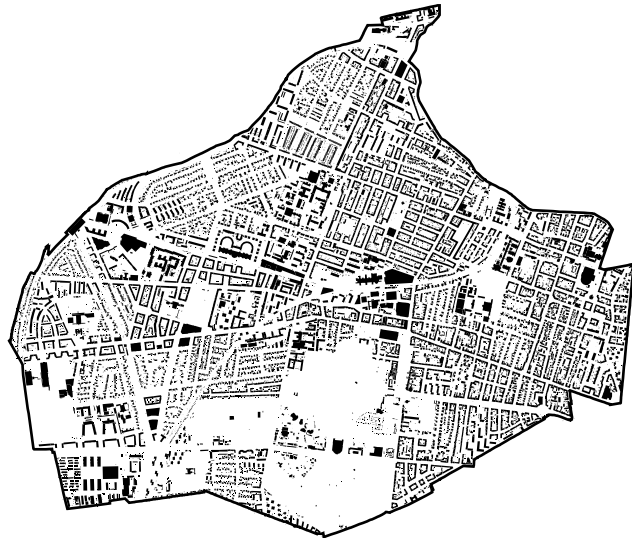

# TYOLOGIER

---

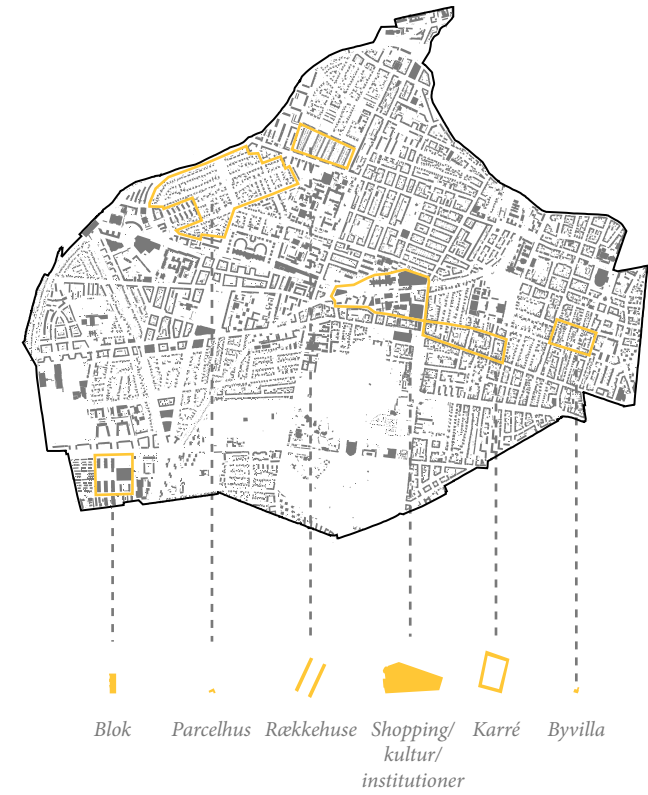

## BYDELE

---

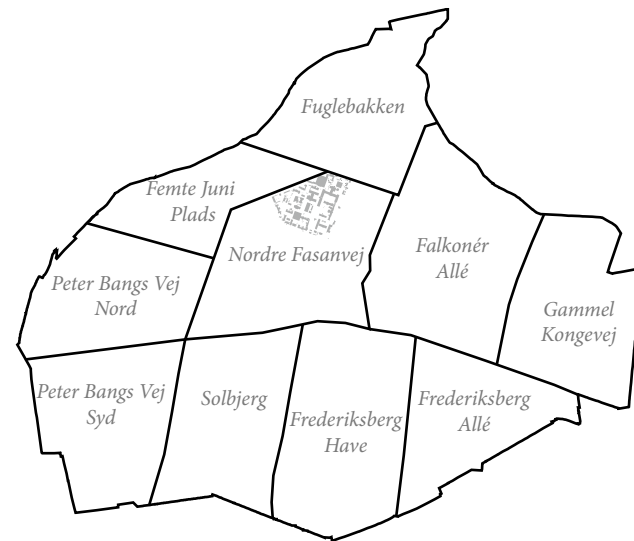

## INFRASTRUKTUR

---

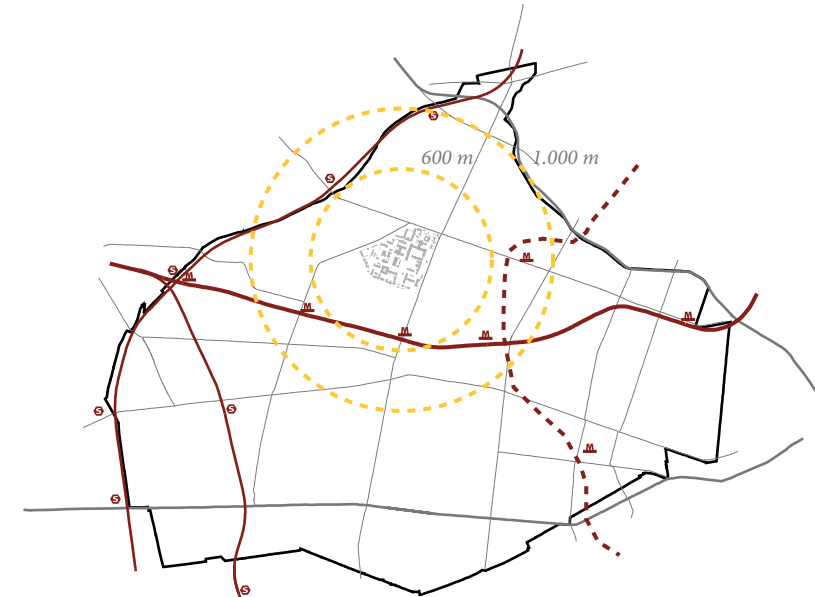

## REKREATIVE OMRÅDER

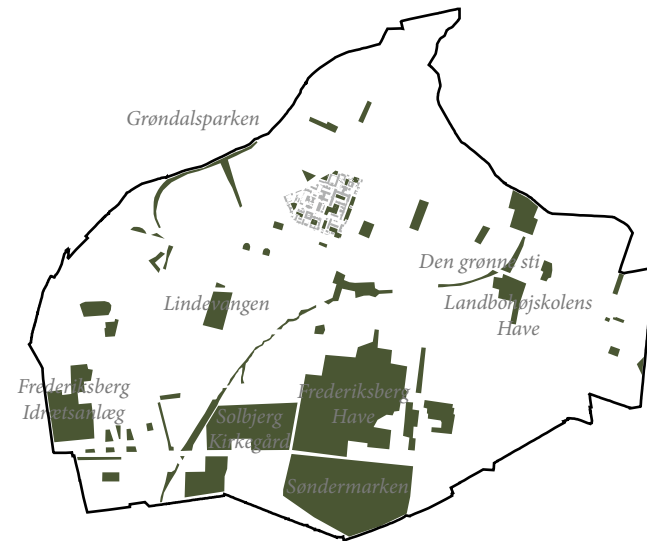

## FUNKTIONER

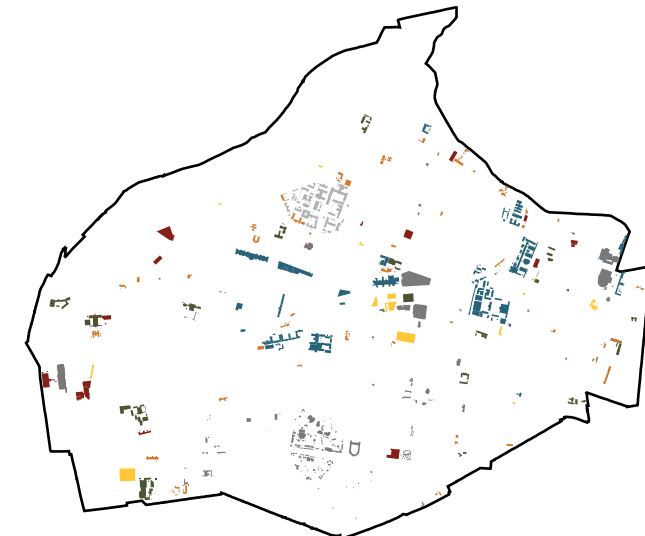

- |  |   |
|--|---|
|  Sportsfaciliteter         |  Videregående uddannelser |
|  Daginstitutioner         |  Kultur                  |
|  Folkeskoler og gymnasier |  Offentlige tilbud       |

## BEVÆGELSE

---

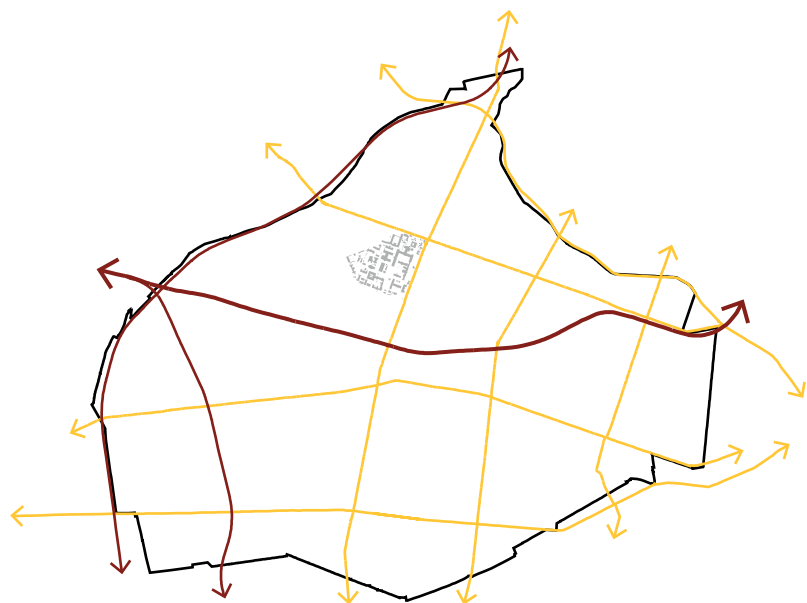

## AKTIVITET

---

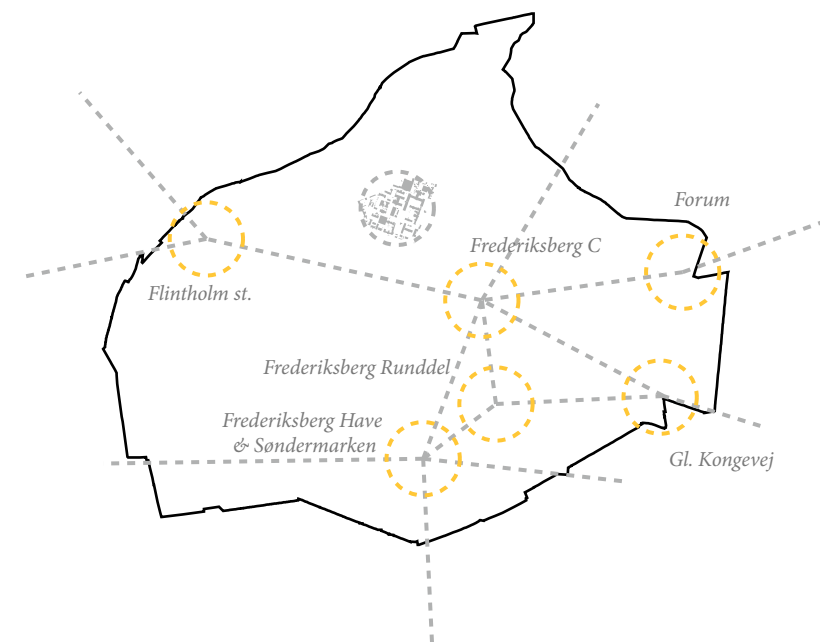



# FREDERIKSBERG HOSPITAL

02

## TYOLOGIER

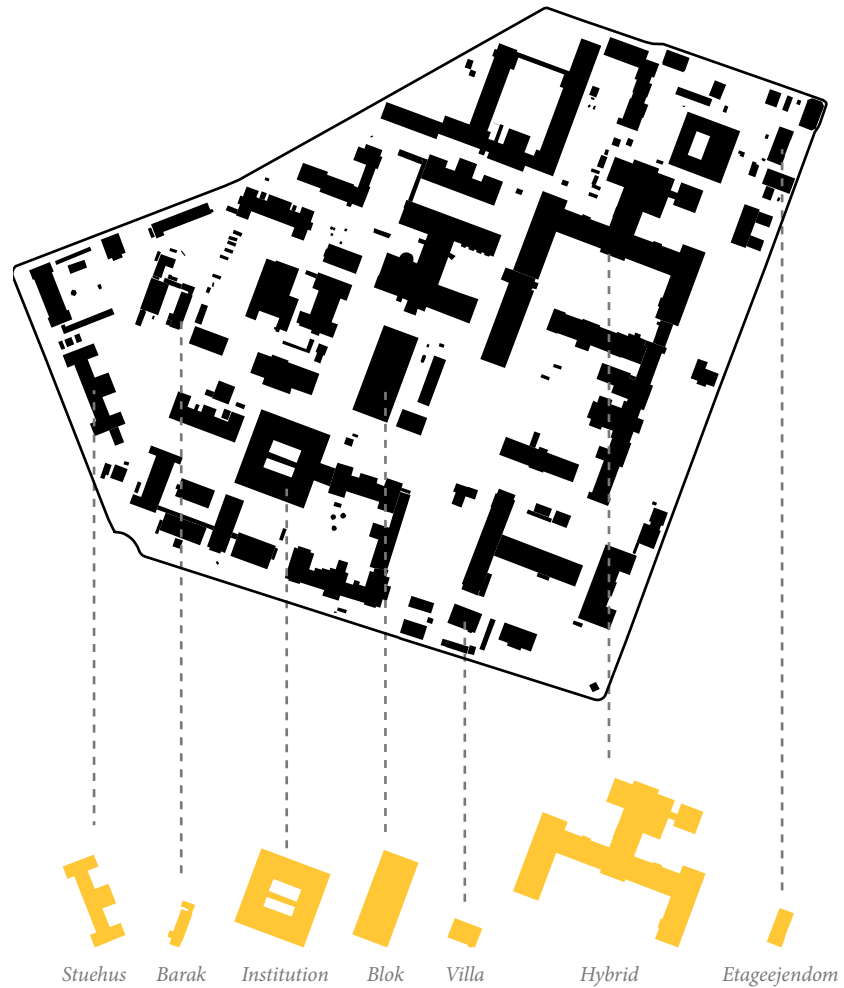

## HISTORISK UDVIKLING

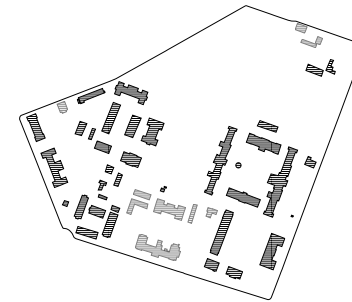

1899

Første etape af hospitalet bygges omkring Københavns Amtssygehus, som blev opført i 1891.

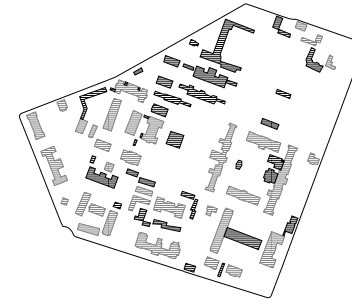

1939

Hospitalet udvides løbende med pavilloner og nye afdelinger og Københavns Amtssygehus bliver en del af Frederiksberg Hospital.

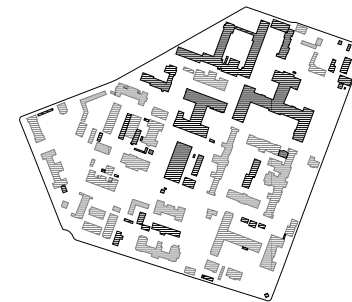

1972

Nye krav betyder, at laboratoriebygningen opføres og mindre servicebygninger kommer til, mens de eksisterende bygninger får mindre tilbygninger

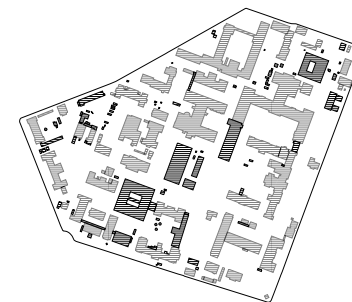

2018

Området i dag med fire daginstitutioner, plejecenter, hospital med psykiatrisk afdeling og andre offentlige tilbud. Nye krav resulterer i udflytning til nye faciliteter på Bispebjerg Hospital.

## MATRIKLER

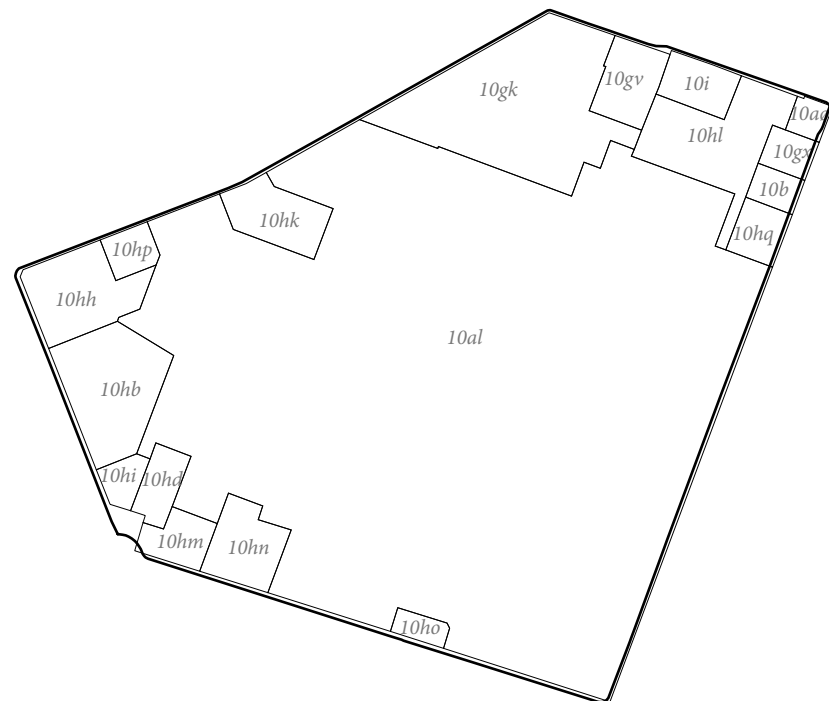



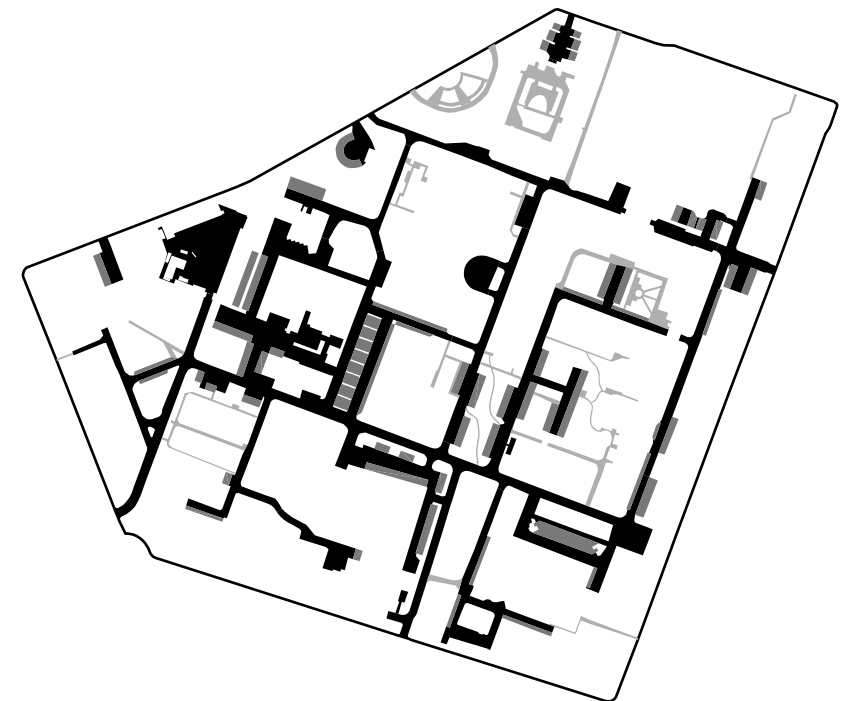

## INFRASTRUKTUR



-  *Veje*
-  *Parkeringspladser*
-  *Stier*



## FUNKTIONER

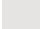

-  *Boliger*
-  *Institution*
-  *Hospital*
-  *Anden offentlig funktion*
-  *Uden funktion*

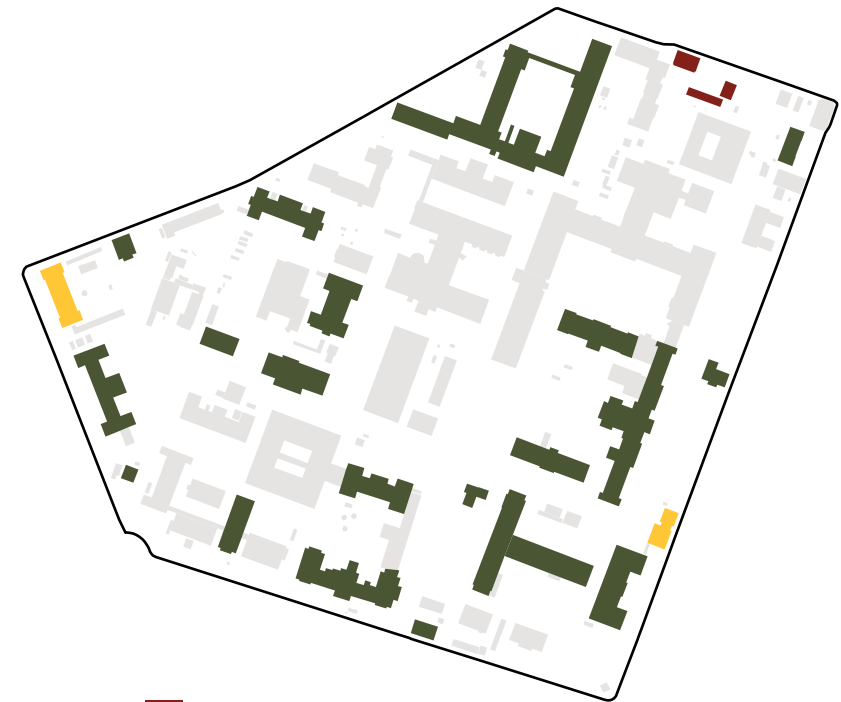
## BEVARINGSVÆRDIER

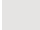

-  *Fredet*
-  *Høj bevaringsværdi*
-  *Middel bevaringsværdi*
-  *Lav eller ingen bevaringsværdi*

## TRÆER

---



## GRØNNE FLADER

---



## BELAGTE FLADER

---

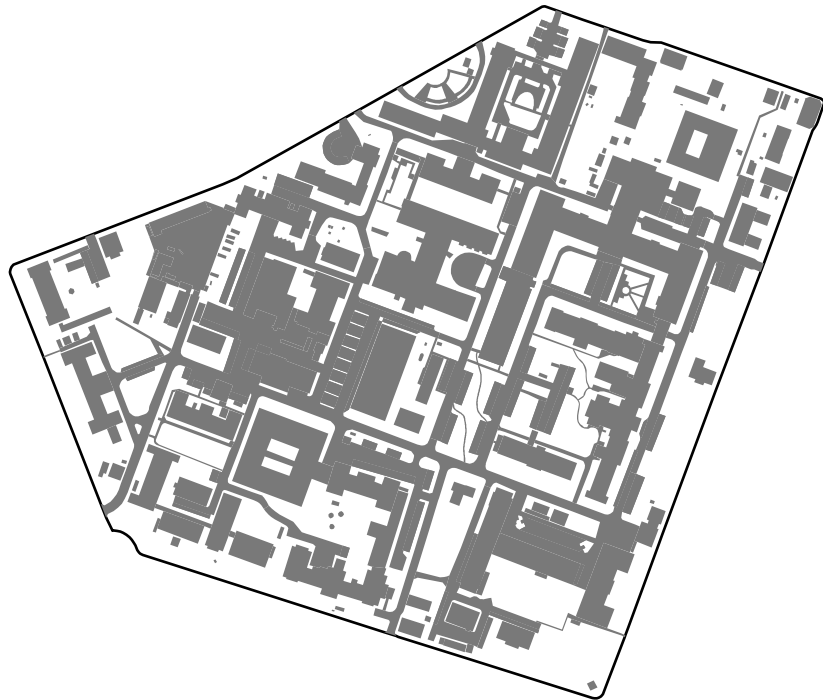

## NEDSIVNING

---

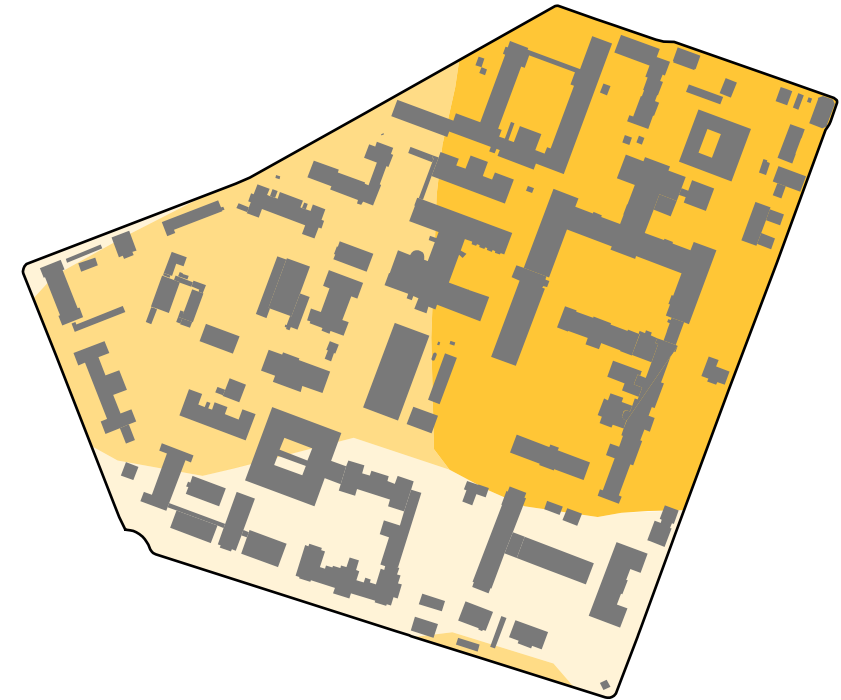

## SÆRLIGE TRÆK

---



## GRÆNSER OG BARRIERE

---



## TILSTØDENDE OMRÅDER

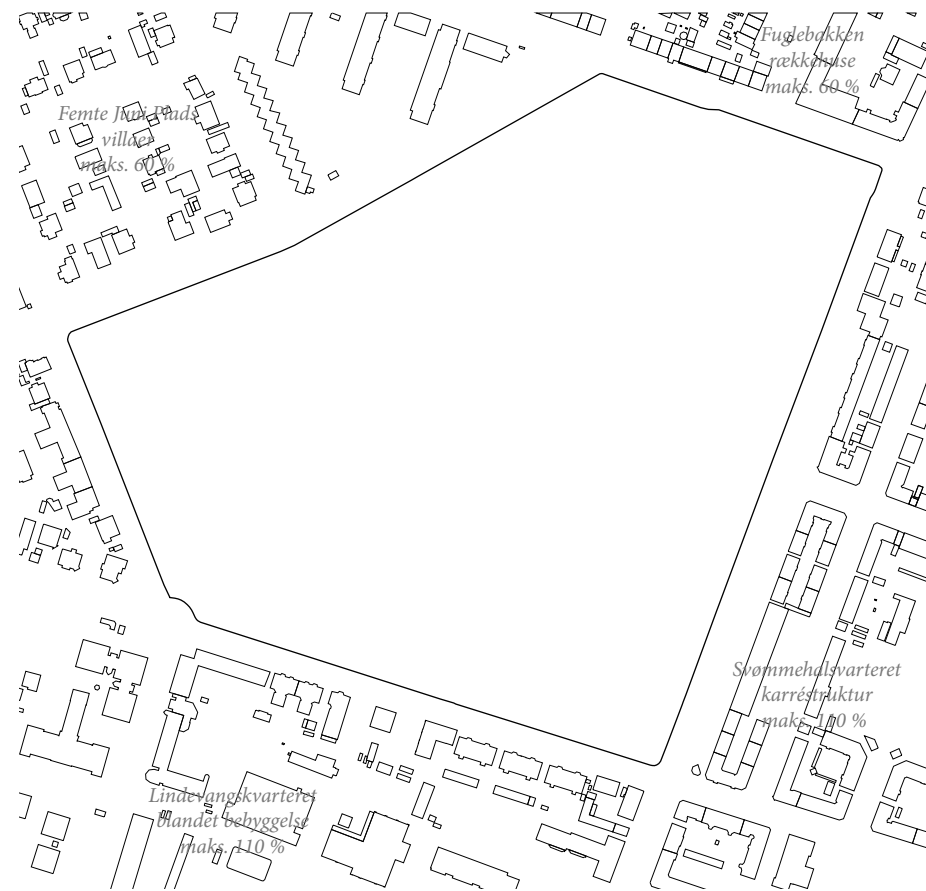

## MATERIALITET

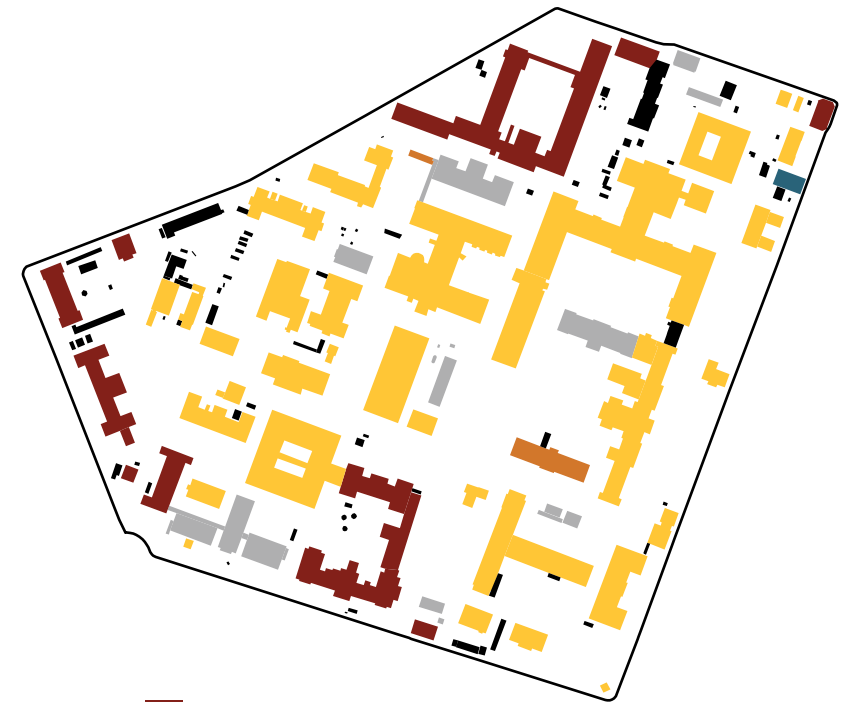

- Røde tegl
- Gule tegl
- Forskellige farver puds
- Særlige farver
- Sort eller mørkt træ



## AKTIVITET

---

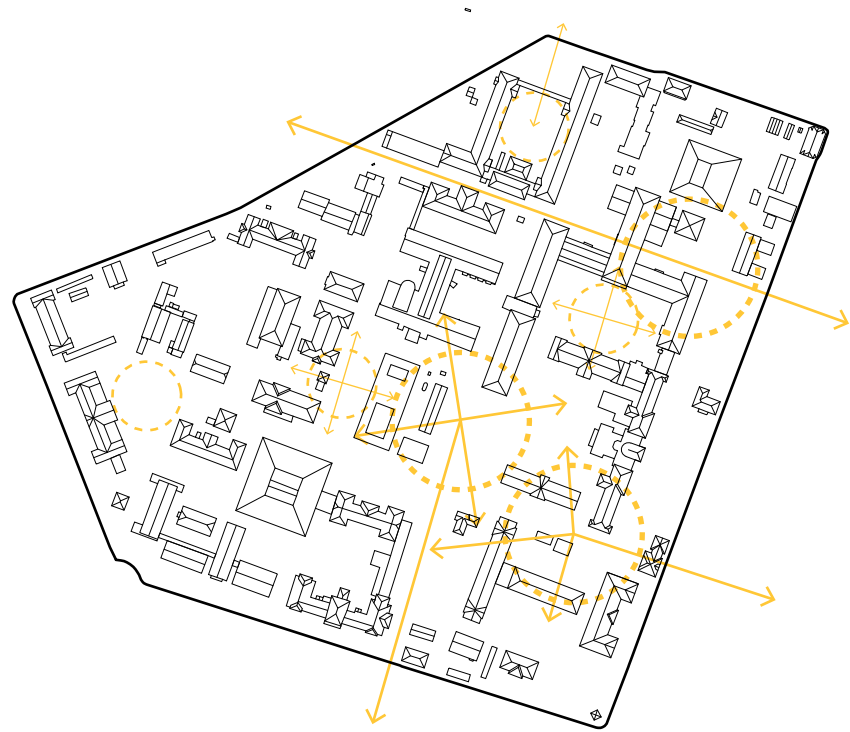

## RETNINGER OG SÆRLIGE BYGNINGER

---

