

et krematorium  
mellem ruin og ritual

[ proces ]

Κεραμεικός / Αθήνα / Νεκρόπολη  
Kerameikós / Athen / Nekropolis

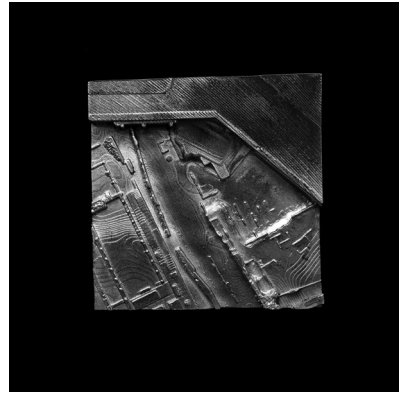

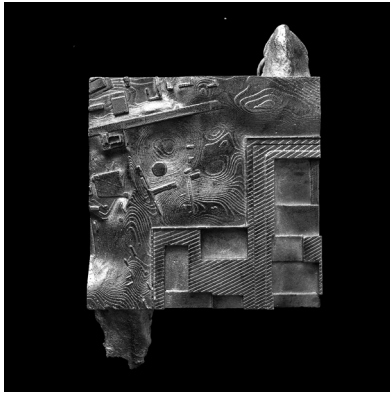
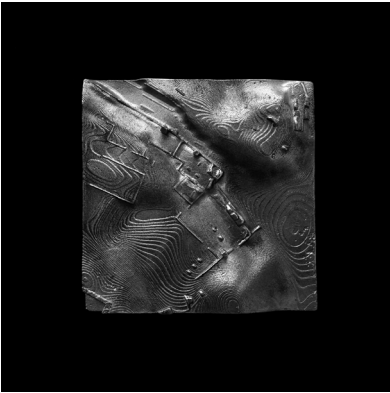

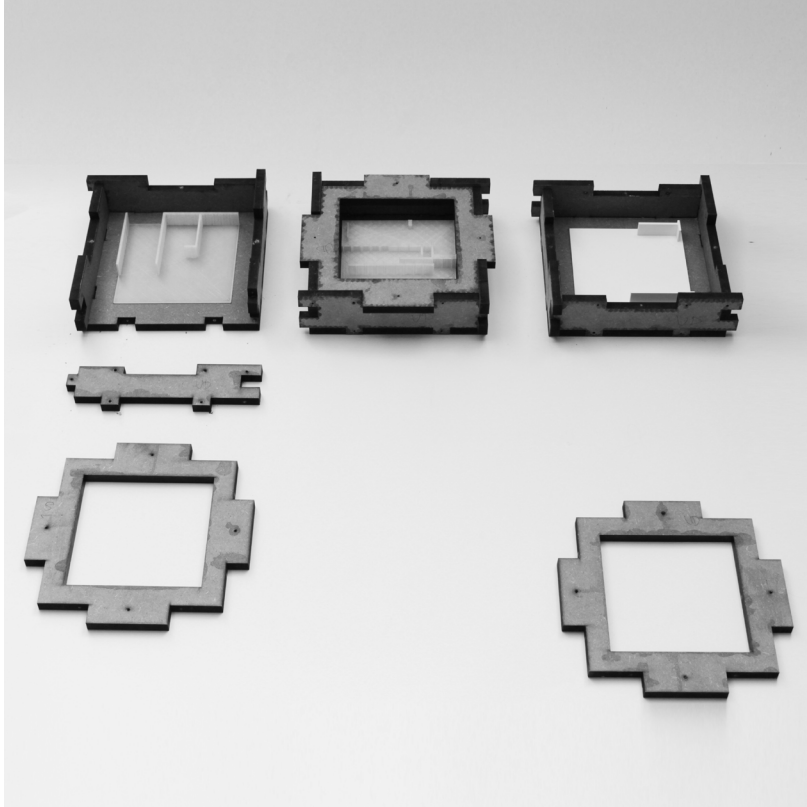

180403 | støbeform, mdf + 3d-print

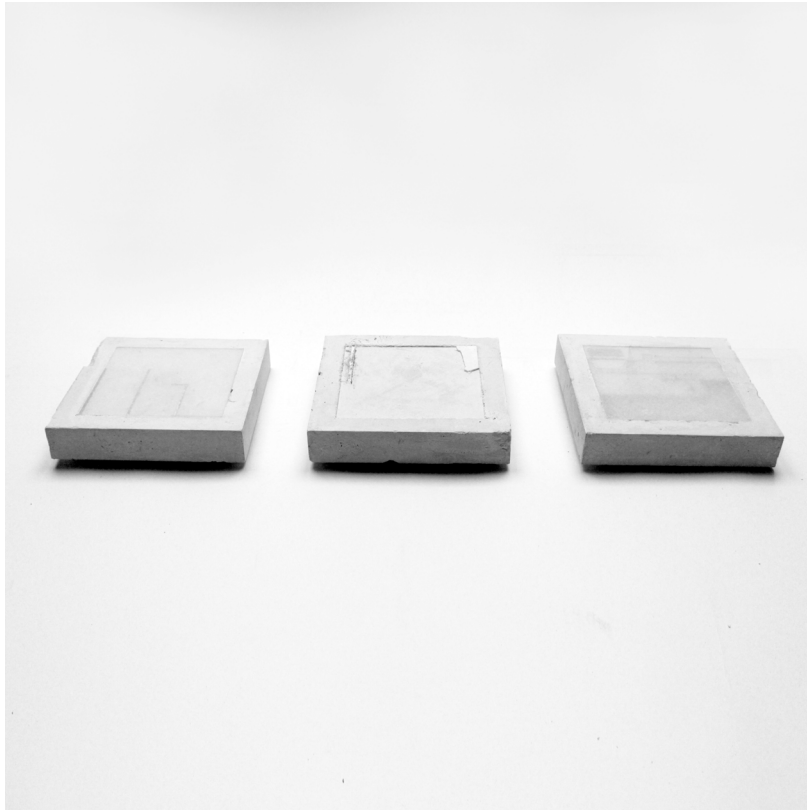

180404 | gipsstøbninger med 3d-print

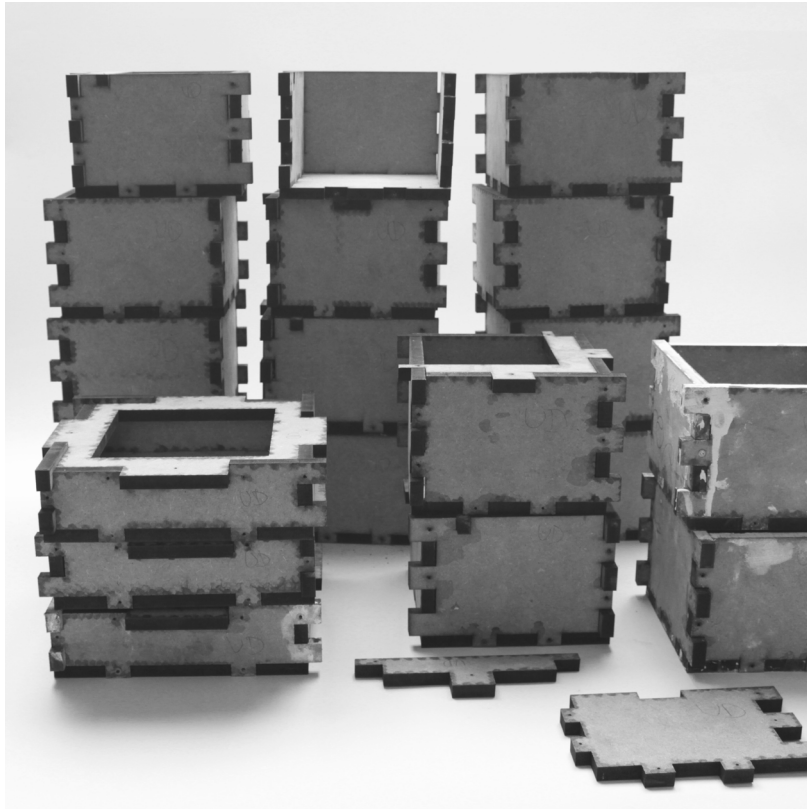

180410 | stobeforme, mdf



180410 | stobeforme efter brug, mdf + 3d-print

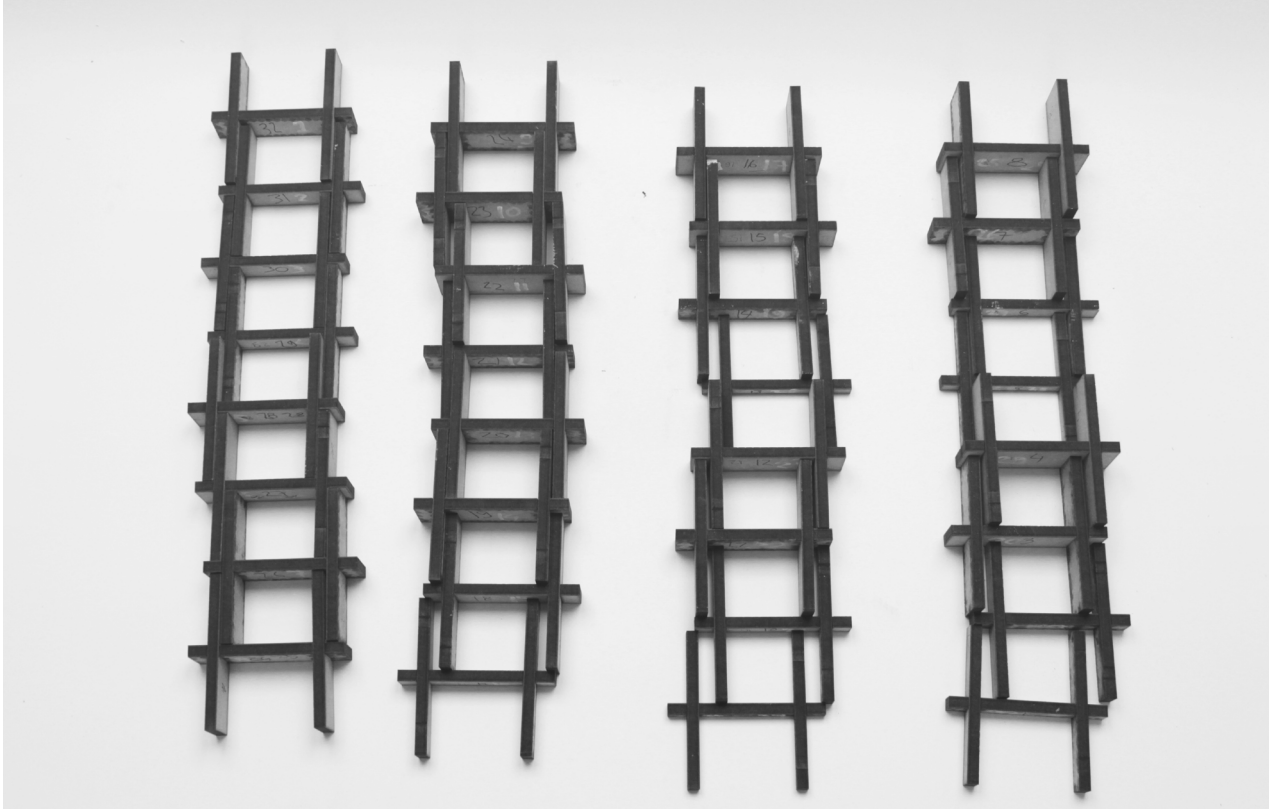

180410 | afstandsklodser til støbeforme, mdf



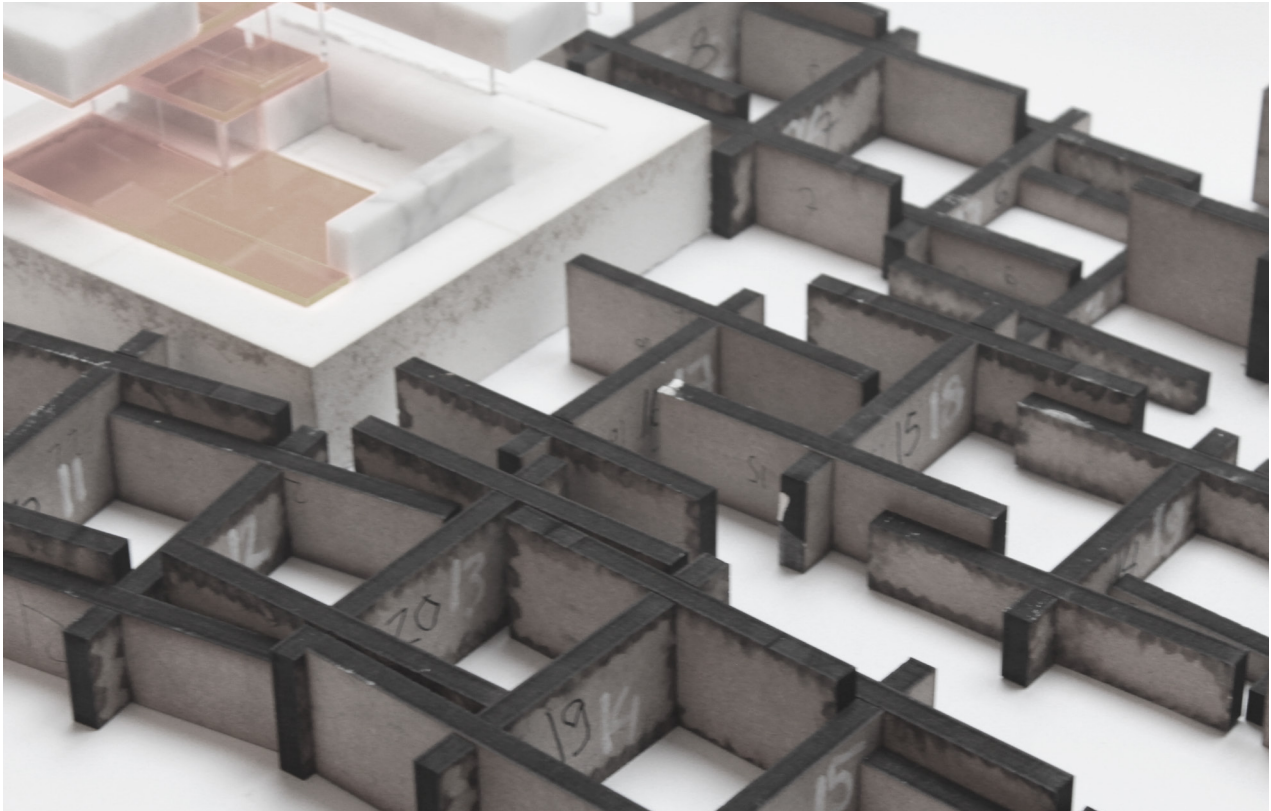

180410 | afstandsklodser til støbeforme + konceptmodel

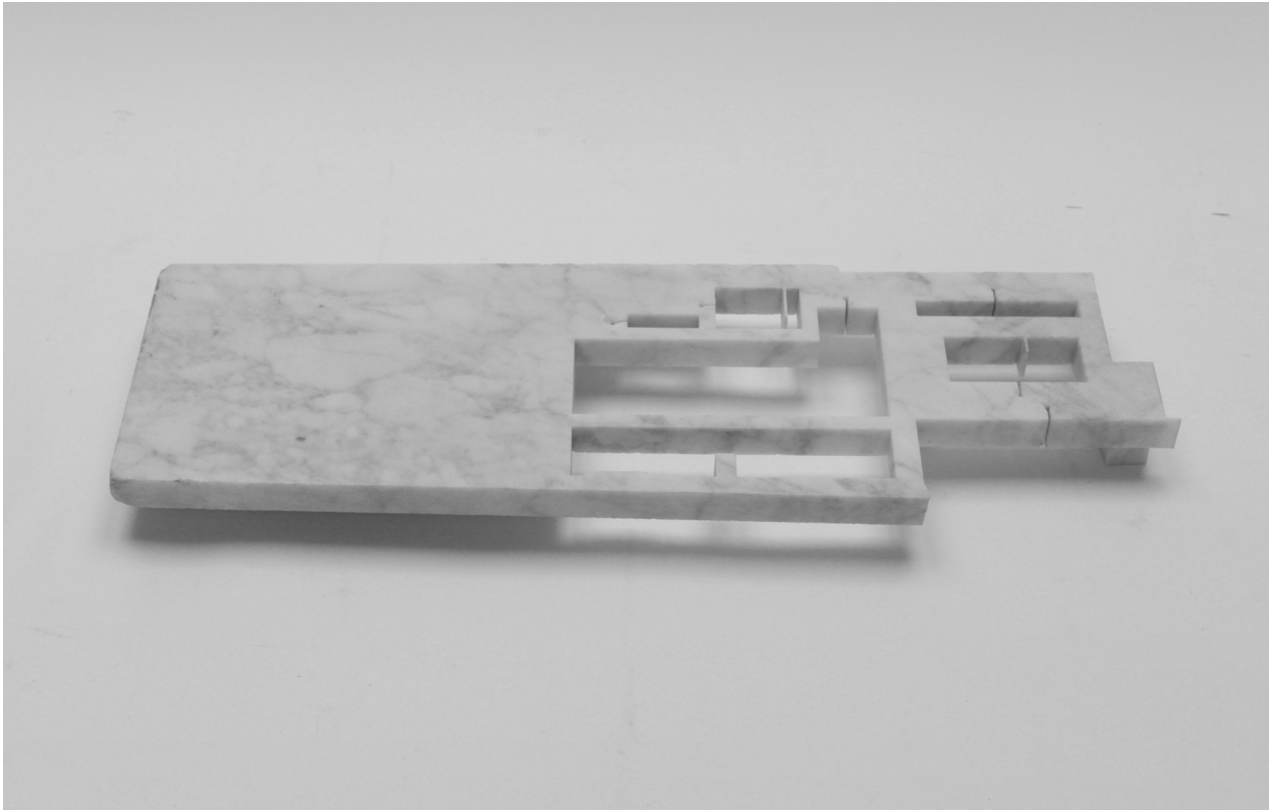

180410 | rest af udsækering, marmor





180410 | model i akryl, marmor og gips

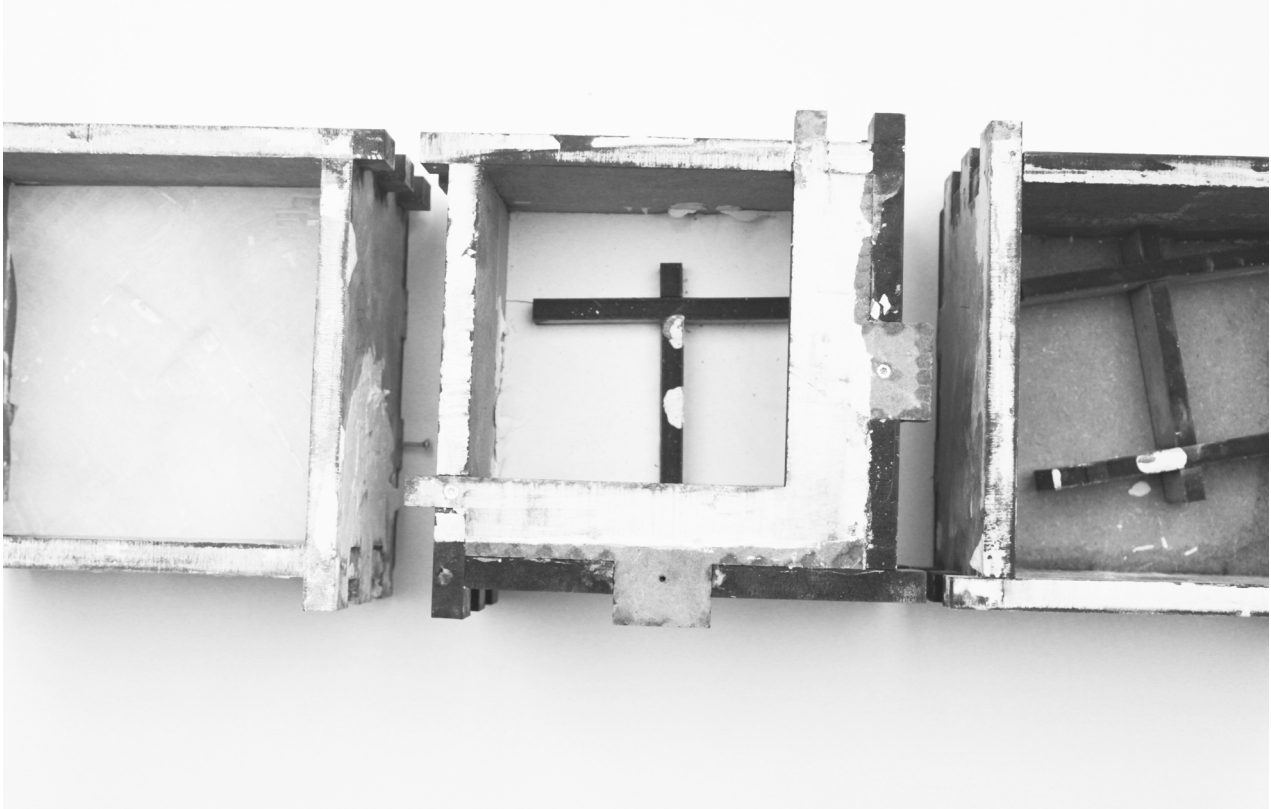

180410 | stobeforme efter brug, mdf + gips + 3d-print



180410 | afstøbning af sitet hvor krematoriet er placeret, aluminium

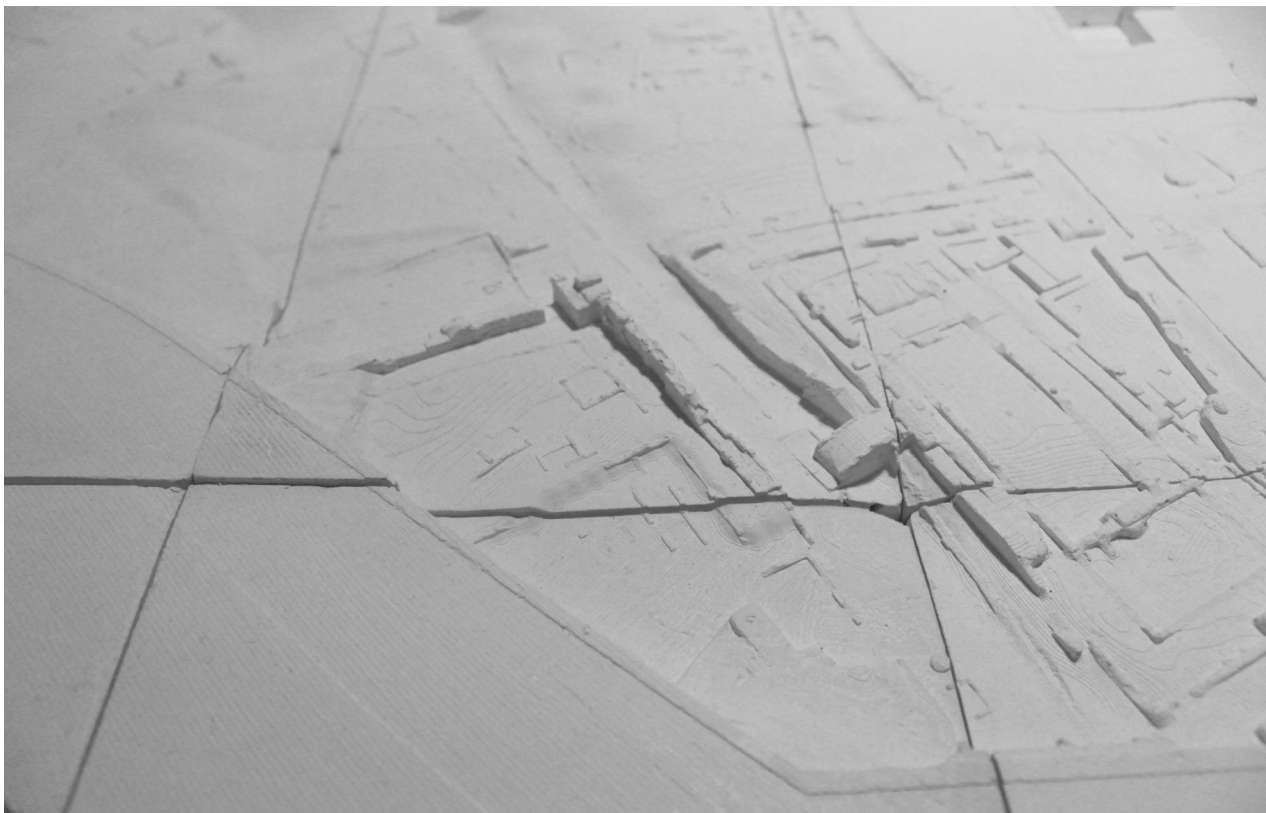

180424 | gipsstøbning, udsnit af kontekst, 1:500

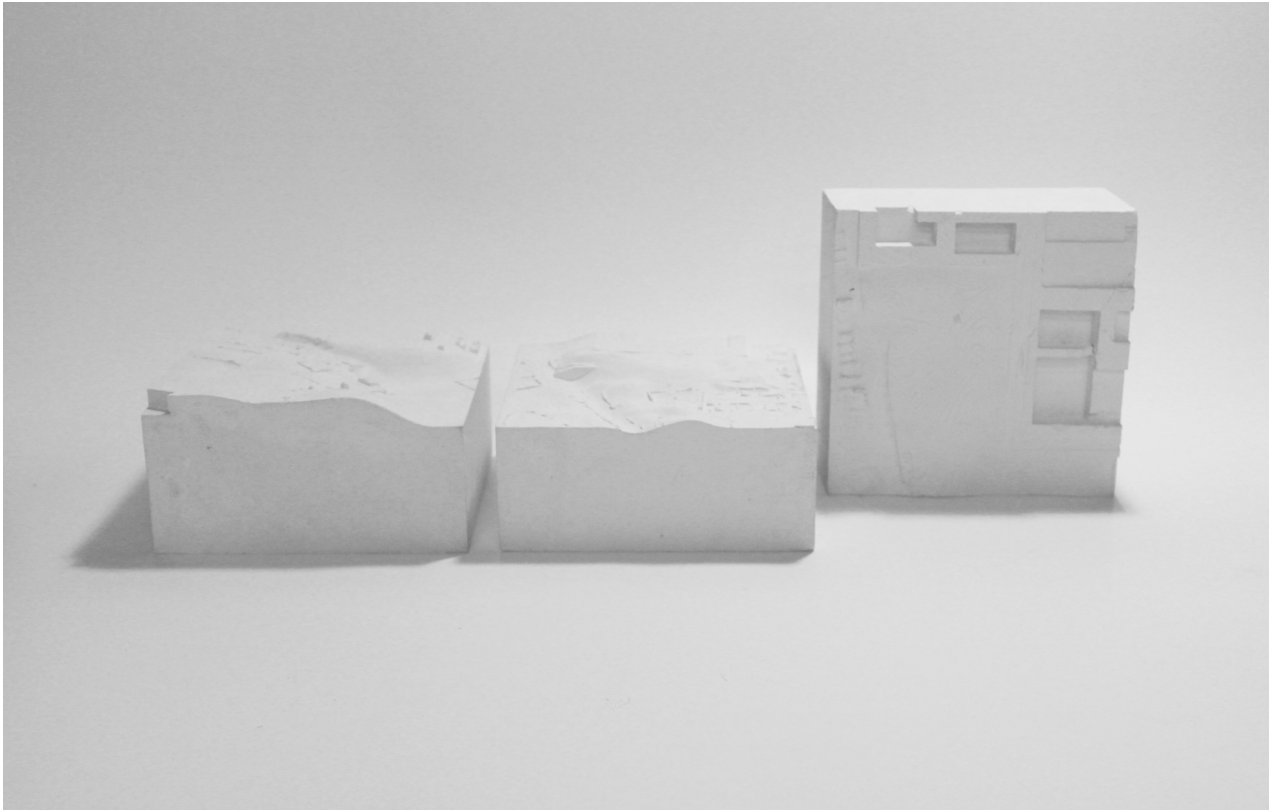

180424 | gipsstøbning, blokke 150mm x 150mm, udsnit af kontekst, 1:500





180424 | marmor, brudflade





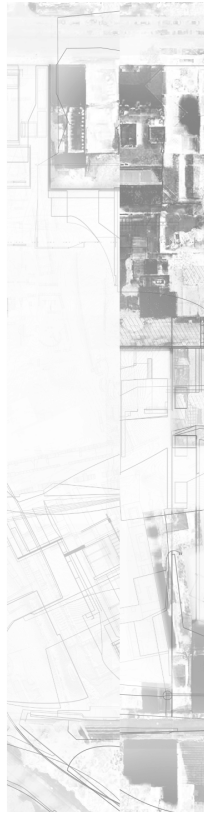



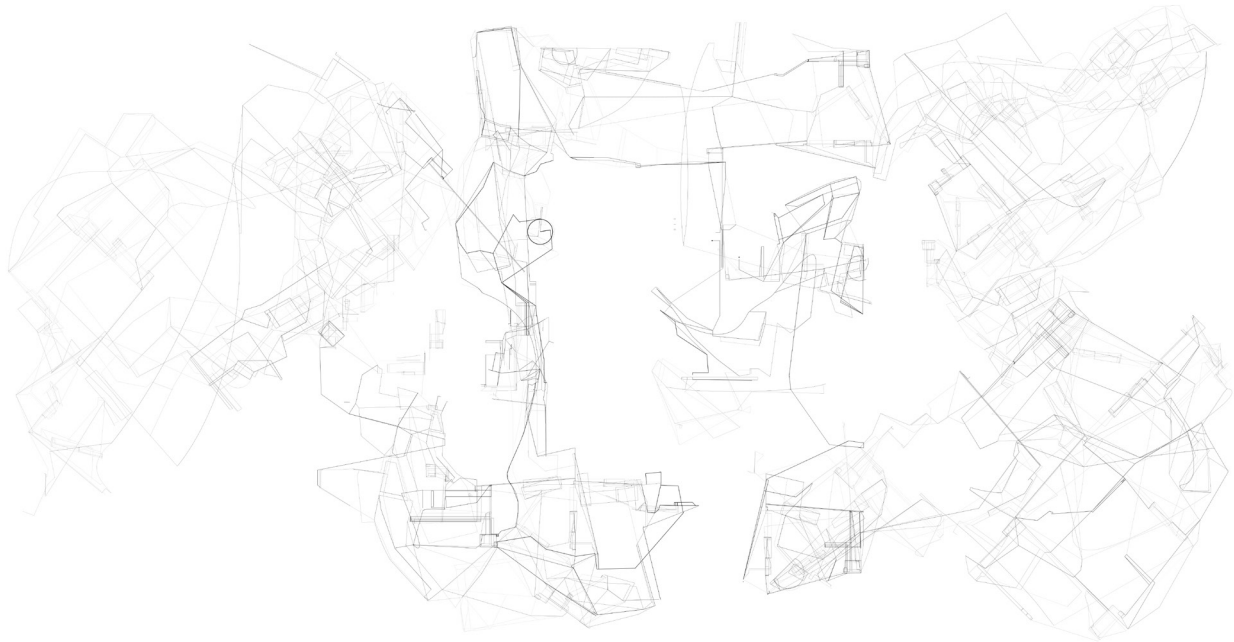

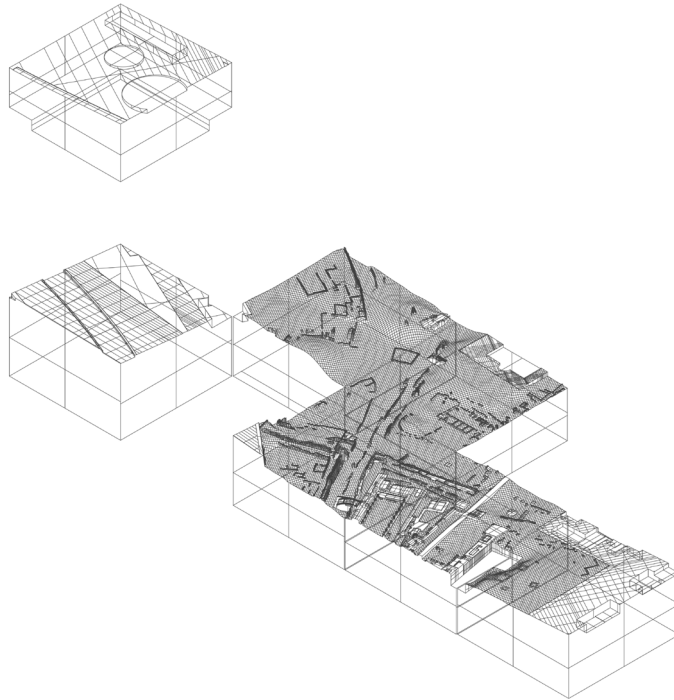

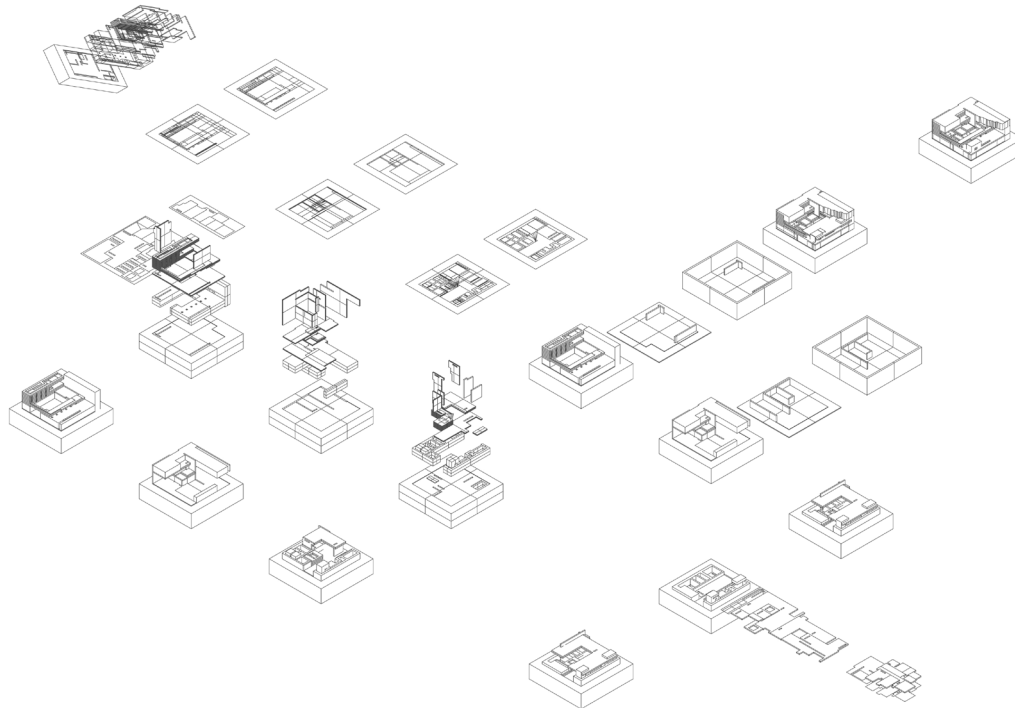



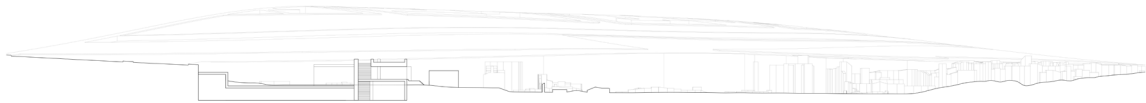

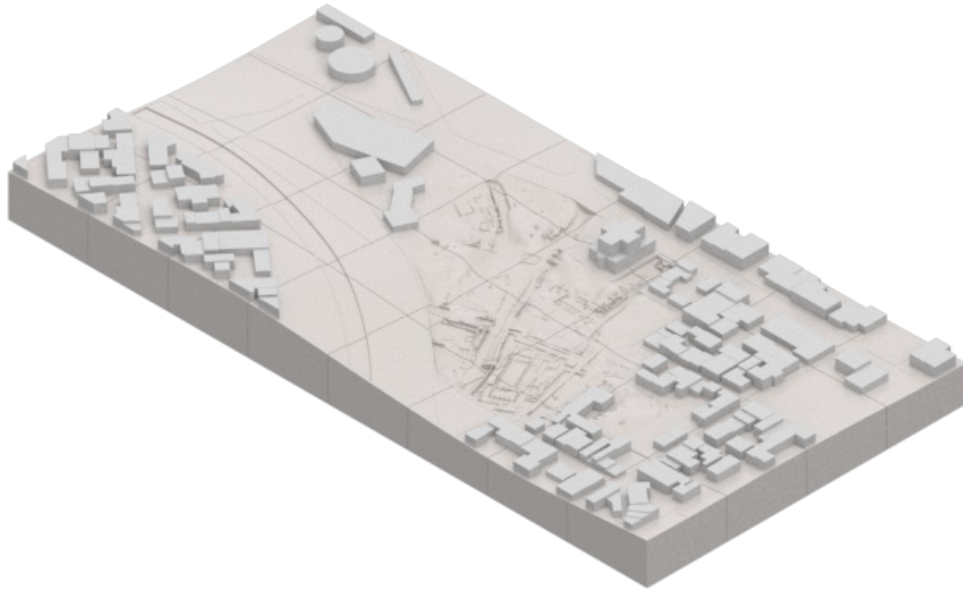

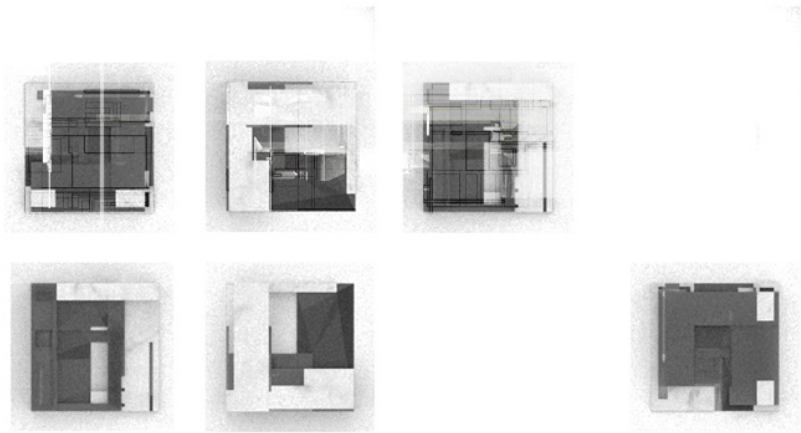



180310 | konceptuel opstilling, 3d-print + aluminium

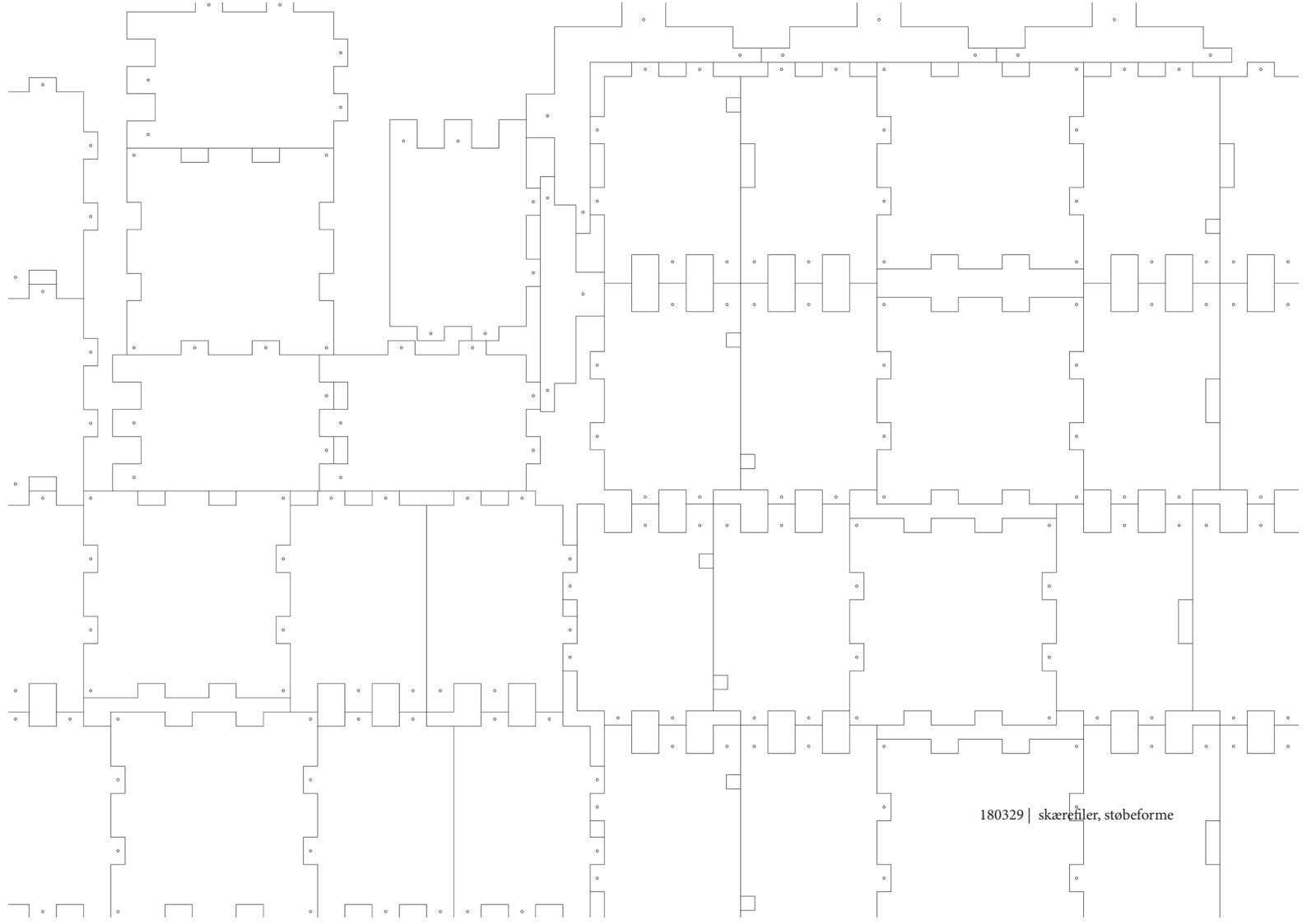

180329 | skærefiler, støbeforme



180405 | teststøbning, gips [resultat: sad fast i støbeform]



180522 | trappe, 1:100, 3d-print

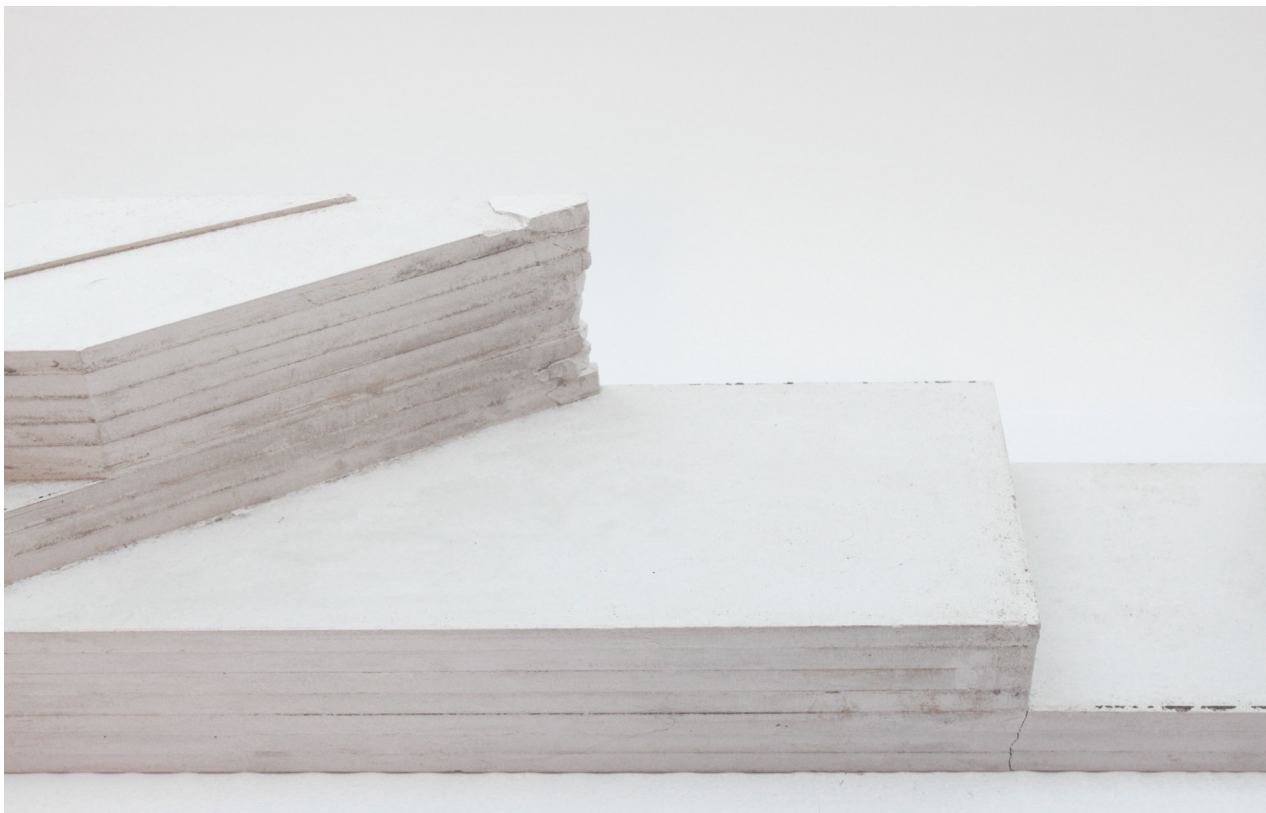

180524 | landskab, 1:100, gips





180503 | landskab pre-indsættelse, 1:500, gips



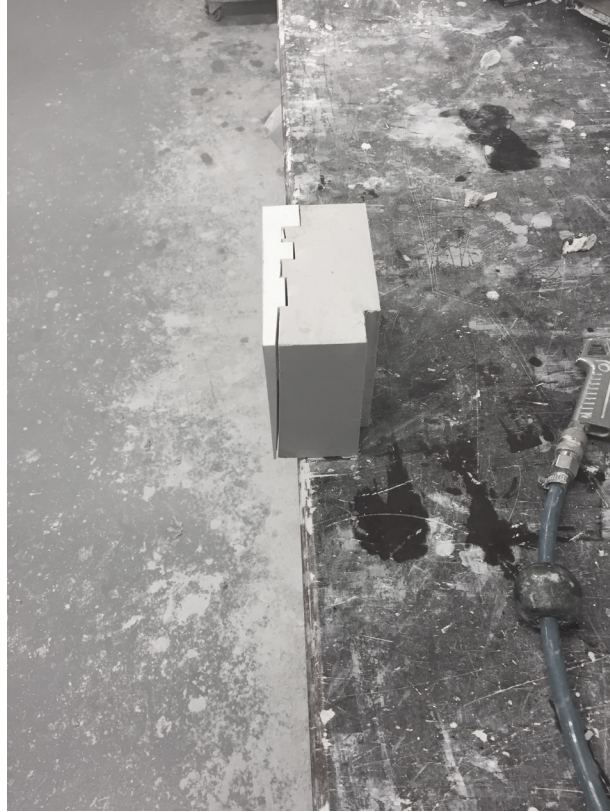

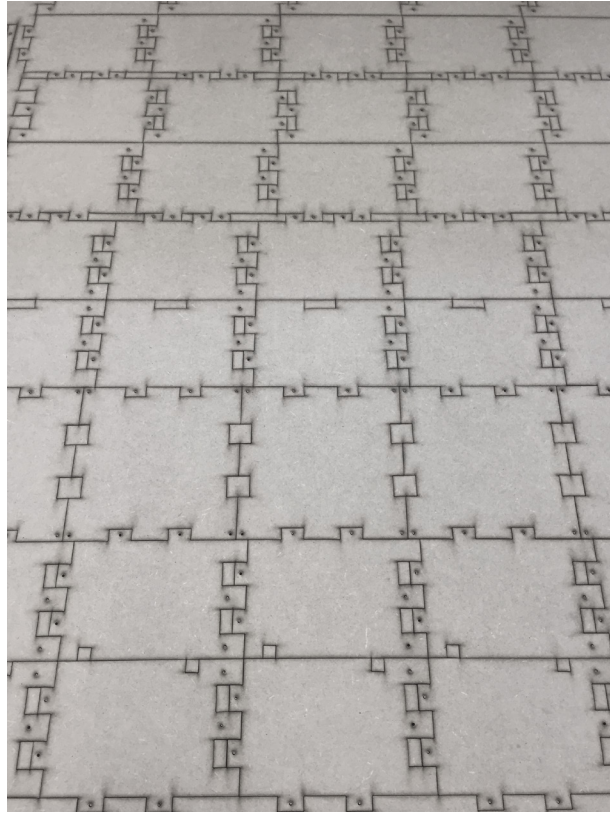

180403 | laserskåret mdf til støbeforme

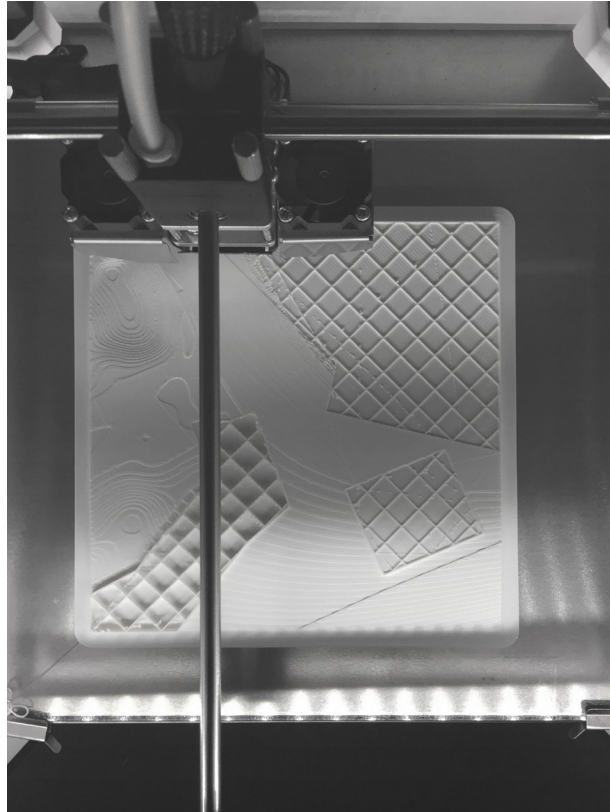



180408 | teststøbning, gips [resultat: for porøs]



180522 | stobepoces, landskab, 1:100, gips

